

Type: CE = Single Inlet

Performance / Dimensions



Type: CE 790/E 35 [220V 1N~ 60 Hz]

MP Capacitor 25 μ F - 400 VDB
Protection type: IP 65

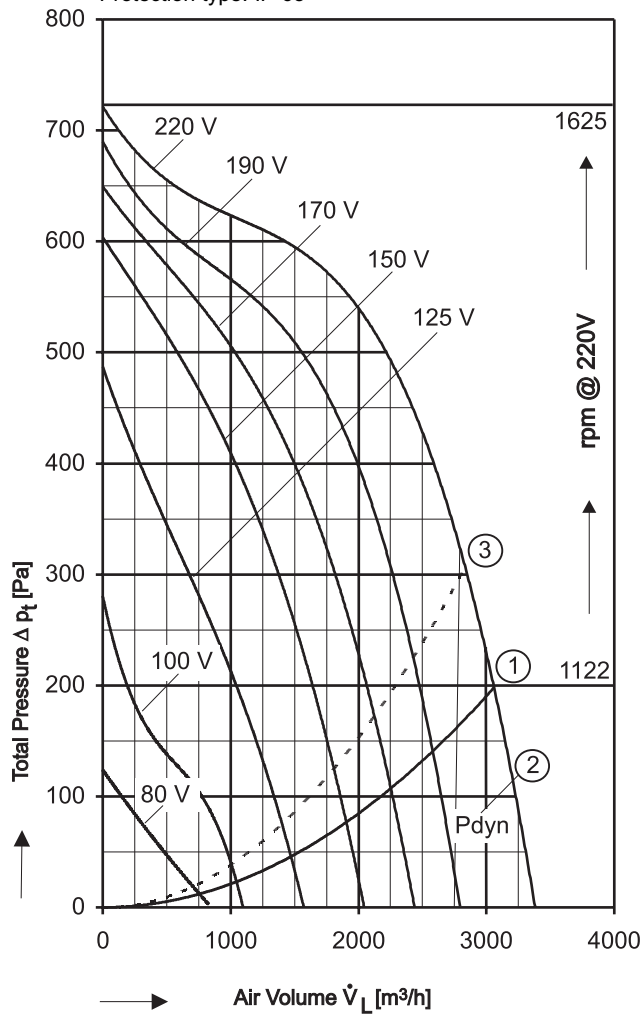

- ① Free air relating to fan discharge area 0,0469 m². Max. permissible ambient temperature 50°C.
- ② Velocity (dynamic) pressure
For Static Pressure Regain see example
- ③ Max. permissible ambient temperature 60°C.

Please state intake side !

For sound data please see extra pages.

Voltage [V]	Air Volume \dot{V}_L [m ³ /h] at $\rho = 1,2$ kg/m ³ and current [A] (bold figures)							
	Free Air	Total Pressure Δp_t [Pa]						
		100	150	200	250	300	350	400
80	765 2,12							
100	1050 2,66	775 2,60	420 2,52					
125	1475 3,32	1340 3,26	1200 3,20	1045 3,14	870 3,06			
150	1900 3,98	1860 3,95	1755 3,87	1640 3,79	1515 3,70	1375 3,60	1220 3,50	1040 3,38
170	2250 4,44		2170 4,37	2065 4,28	1950 4,18	1820 4,07	1670 3,95	1500 3,82
190	2585 4,86		2565 4,84	2475 4,75	2380 4,66	2270 4,56	2140 4,44	1990 4,30
220	3060 5,41			3055 5,40	2960 5,30	2850 5,17	2730 5,05	2590 4,90

Save power and even more silent FISCHBACH SPEED CONTROLLERS Manual and Automatic		
Voltage Control	Type*	Order-No.*
Stepless 0 - 100% and 100% - 0	FDR 80	6164
Stepwise 7 Steps	FDR 750	6202
FISCHBACH AUTOMATIC CONTROL **	FRA 80	6253

* For further details see resp. catalogue pages
** For details of sensors etc., on request

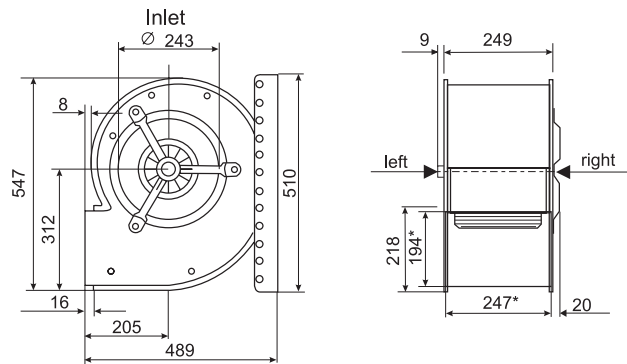

* External dimension of discharge



The Silent One