

Type: CE = Single Inlet

Performance / Dimensions



Type: CE 9-090/D 2 [400V 3N~ 50 Hz]
Protection type: IP 65

Please state intake side !
For sound data please see extra pages.

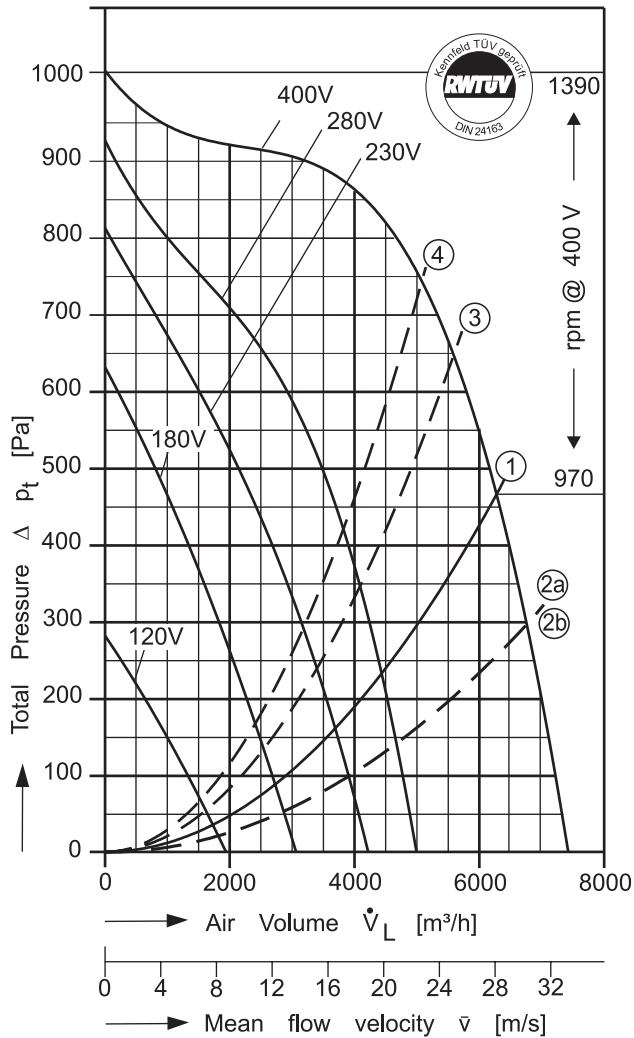

$P_{max} = 3,76 \text{ kW}$ $I_A / I_N = 2,2$ $I_{max} = 7,10 \text{ A}$

- ① System curve free air related to standard fan discharge surface of 0,062 m². Max. permissible air temperature: 40° C
- ②a System curve incl. pressure regain by means of TRANSITION PIECE (square to round, FISCH-BACH accessory) with connected duct. Duct length: 1,8 m.
- ②b System curve incl. pressure regain by means of DIFFUSER ANGLE FRAME (FISCHBACH accessory) with connected duct. Duct length: 2,3 m.
- ③ For operating points above that curve a maximum air temperature of 50° C is allowed.
- ④ For operating points above that curve a maximum air temperature of 60° C is allowed.

Voltage [V]	Air Volume \dot{V}_L [m³/h] at $\rho = 1,2 \text{ kg/m}^3$ and current [A] (bold figures, 2nd. line)							
	Free Air	Total Pressure Δp_t [Pa]						
		100	200	300	400	500	650	800
120	1745 3,36	1320 3,24	640 2,99					
180	2760 4,77	2680 4,73	2270 4,48	1820 4,16	1340 3,80	800 3,43		
230	3680 5,77		3540 5,65	3140 5,28	2680 4,84	2140 4,33	1160 3,50	
280	4440 6,21			4230 6,04	3900 5,75	3480 5,36	2550 4,47	1000 3,21
400	6255 7,10					6160 7,02	5570 6,58	4670 5,85

Save power and even more silent with FISCHBACH SPEED CONTROLLERS FISCHBACH AUTOMATIC CONTROLLERS

Voltage Control	Type*	Order-No.*
Stepless, 0 - 100% and 100% - 0	FDR 80/3	6232
Stepwise, 5 Steps	FDR 8.0/3	6183
FISCHBACH AUTOMATIC CONTROL**	FRA 80/3	6282
Frequency Inverter FFU	on request	

* For further details see resp. catalogue pages
** For details of sensors etc., on request

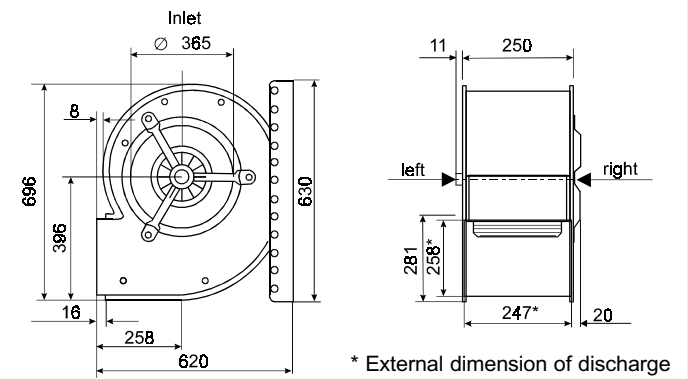

* External dimension of discharge

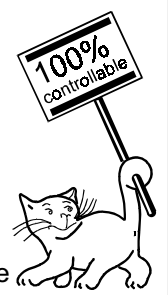

The Silent One

In the above diagram the **TOTAL** pressure (the sum of the dynamic and static pressures) is shown in relation to the air volume, dynamic pressure is shown below system line No.1. Static pressure is shown above that line.

To regain static pressure and reduce dynamic pressure connect a suitable transition piece on the fan outlet.

We do not guarantee for fans not being operated in consideration of those restrictions.