

# Type: CFE = Single Inlet "superflat" Performance / Dimensions



## Type: CFE 540/E 1 [230V 1N~ 50 Hz]

MP Capacitor 10  $\mu$ F - 400 VDB  
Protection type: IP 65

Please state intake side !

For sound data please see extra pages.

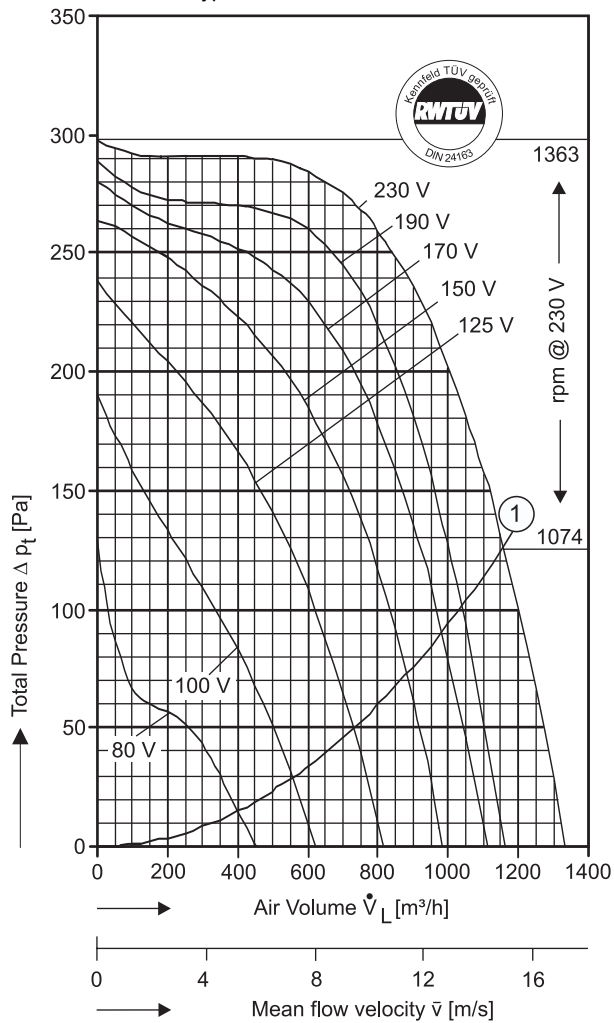

$P_{max} = 0,379 \text{ kW}$   $I_A / I_N = 1,6$   $I_{max} = 1,65 \text{ A}$

1 System curve for dynamical pressure part related to fan discharge surface of 0,0220 m<sup>2</sup>. For operating points above that curve a max. air temperature of 60°C is allowed (Curve for free blowing fan).

Voltage [V]	Air Volume $\dot{V}_L$ [m <sup>3</sup> /h] at $\rho = 1,2 \text{ kg/m}^3$ and current [A] (bold figures, 2nd. line)							
	Free Air	Total Pressure $\Delta p_t$ [Pa]						
		50	100	150	175	200	250	275
80	396 <b>0,66</b>	264 <b>0,65</b>	30 <b>0,62</b>					
100	557 <b>0,82</b>	500 <b>0,81</b>	362 <b>0,78</b>	125 <b>0,73</b>				
125	730 <b>1,01</b>	730 <b>1,01</b>	625 <b>0,98</b>	475 <b>0,92</b>	363 <b>0,89</b>	225 <b>0,83</b>		
150	884 <b>1,17</b>		825 <b>1,15</b>	725 <b>1,11</b>	637 <b>1,08</b>	525 <b>1,03</b>		
170	955 <b>1,30</b>		983 <b>1,29</b>	875 <b>1,25</b>	800 <b>1,21</b>	725 <b>1,17</b>	425 <b>1,04</b>	
190	1034 <b>1,41</b>		1034 <b>1,41</b>	962 <b>1,38</b>	912 <b>1,35</b>	850 <b>1,31</b>	675 <b>1,23</b>	125 <b>1,06</b>
230	1169 <b>1,65</b>			1125 <b>1,64</b>	1063 <b>1,60</b>	1000 <b>1,58</b>	850 <b>1,53</b>	700 <b>1,50</b>

Save power and even more silent with FISCHBACH SPEED CONTROLLERS FISCHBACH AUTOMATIC CONTROLLERS

Voltage Control	Type*	Order-No.*
Stepless, 0 - 100% and 100% - 0	FDR 32	6162
Stepwise, 7 Steps	FDR 420	6201
FISCHBACH AUTOMATIC CONTROL **	FRA 32	6251

\* For further details see resp. catalogue pages  
\*\* For details of sensors etc., on request

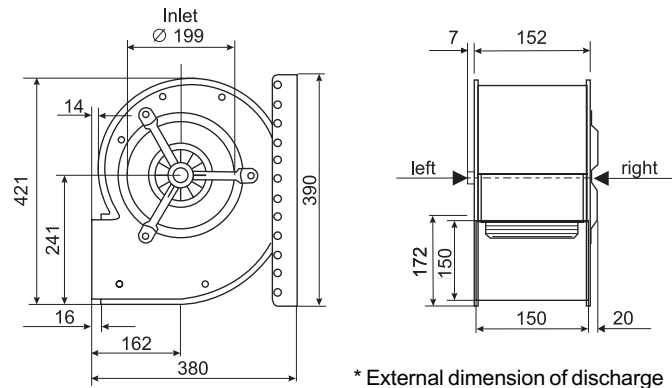

In the above diagram the **TOTAL** pressure (the sum of the dynamic and static pressures) is shown in relation to the air volume, dynamic pressure is shown below system line No.1. Static pressure is shown above that line.