

# Type: CFE = Single Inlet "superflat" Performance / Dimensions

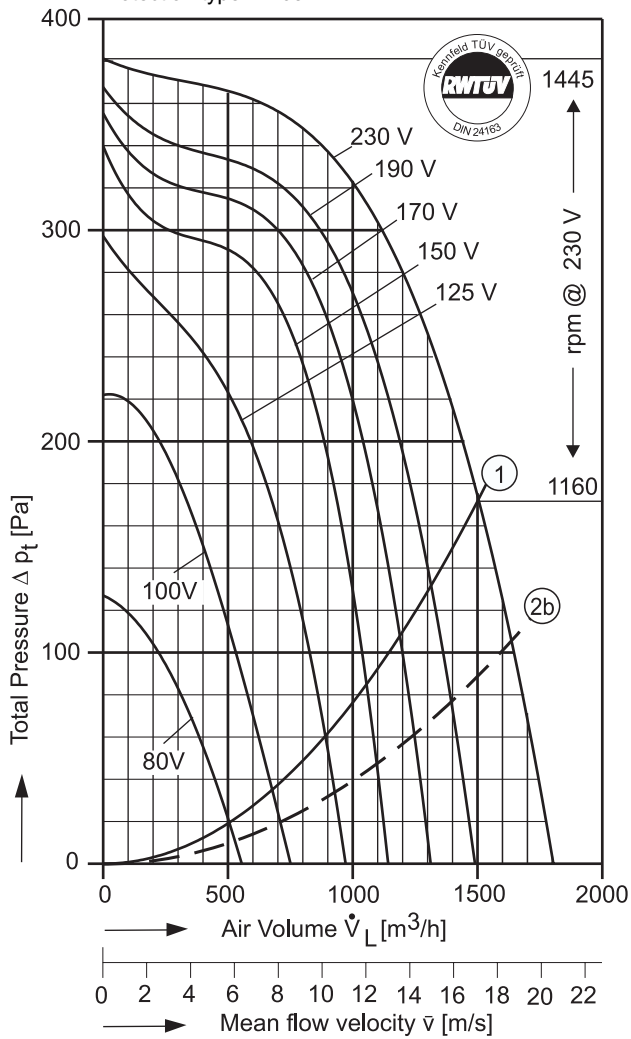

**Type: CFE 640/E 15 [230V 1N~ 50 Hz]**  
 MP Capacitor 12 µF - 400 VDB  
 Protection type: IP 65

Please state intake side !  
 For sound data please see extra pages.



**$P_{max} = 0,45 \text{ kW}$      $I_A / I_N = 1,5$      $I_{max} = 2,05 \text{ A}$**

① System curve for dynamical pressure part related to fan discharge surface of 0,0244 m<sup>2</sup>. Max. permissible air temperature: 60°C.

②b System curve incl. pressure regain by means of DIFFUSER ANGLE FRAME with connected duct. Duct length: 1,7 m.

| Voltage [V] | Air Volume $\dot{V}_L$ [m <sup>3</sup> /h] at $\rho = 1,2 \text{ kg/m}^3$ and current [A] (bold figures, 2nd. line) |                                  |                    |                     |                     |                     |                     |                    |
|-------------|---|----------------------------------|--------------------|---------------------|---------------------|---------------------|---------------------|--------------------|
|             | Free Air  | Total Pressure $\Delta p_t$ [Pa] |                    |                     |                     |                     |                     |                    |
|             |   | 40                               | 80                 | 120                 | 160                 | 200                 | 300                 | 350                |
| 80          | 505<br><b>0,92</b>  | 450<br><b>0,91</b>               | 310<br><b>0,87</b> |                     |                     |                     |                     |                    |
| 100         | 675<br><b>1,16</b>  | 665<br><b>1,15</b>               | 580<br><b>1,11</b> | 485<br><b>1,06</b>  | 375<br><b>1,00</b>  |                     |                     |                    |
| 125         | 890<br><b>1,42</b>  |                                  | 860<br><b>1,40</b> | 790<br><b>1,34</b>  | 710<br><b>1,28</b>  | 590<br><b>1,18</b>  |                     |                    |
| 150         | 1050<br><b>1,64</b>   |                                  |                    | 1010<br><b>1,59</b> | 960<br><b>1,53</b>  | 890<br><b>1,44</b>  |                     |                    |
| 170         | 1195<br><b>1,78</b>   |                                  |                    | 1170<br><b>1,75</b> | 1110<br><b>1,68</b> | 1040<br><b>1,60</b> | 700<br><b>1,27</b>  |                    |
| 190         | 1315<br><b>1,87</b>   |                                  |                    |                     | 1270<br><b>1,82</b> | 1190<br><b>1,74</b> | 870<br><b>1,44</b>  |                    |
| 230         | 1510<br><b>2,05</b>   |                                  |                    |                     |                     | 1440<br><b>1,99</b> | 1120<br><b>1,73</b> | 780<br><b>1,47</b> |

Save power and even more silent with  
**FISCHBACH SPEED CONTROLLERS**  
**FISCHBACH AUTOMATIC CONTROLLERS**

| Voltage Control                 | Type*   | Order-No.*  |
|---------------------------------|---------|-------------|
| Stepless, 0 - 100% and 100% - 0 | FDR 32  | <b>6162</b> |
| Stepwise, 7 Steps               | FDR 420 | <b>6201</b> |
| FISCHBACH AUTOMATIC CONTROL **  | FRA 32  | <b>6251</b> |

\* For further details see resp. catalogue pages  
 \*\* For details of sensors etc., on request

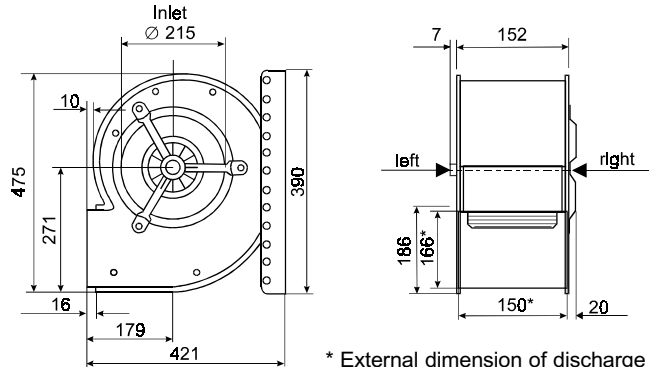

In the above diagram the **TOTAL** pressure (the sum of the dynamic and static pressures) is shown in relation to the air volume, dynamic pressure is shown below system line No.1. Static pressure is shown above that line.

To regain static pressure and reduce dynamic pressure connect a suitable transition piece on the fan outlet.