

Type: CFE = Single Inlet "Superflat" Performance / Dimensions

**FISCHBACH
COMPACT
FAN**

Type: CFE 840/E 35 [230V 1N~ 50 Hz]

MP Capacitor 25 µF - 400 VDB
Protection type: IP 65

Please state intake side !

For sound data please see extra pages.

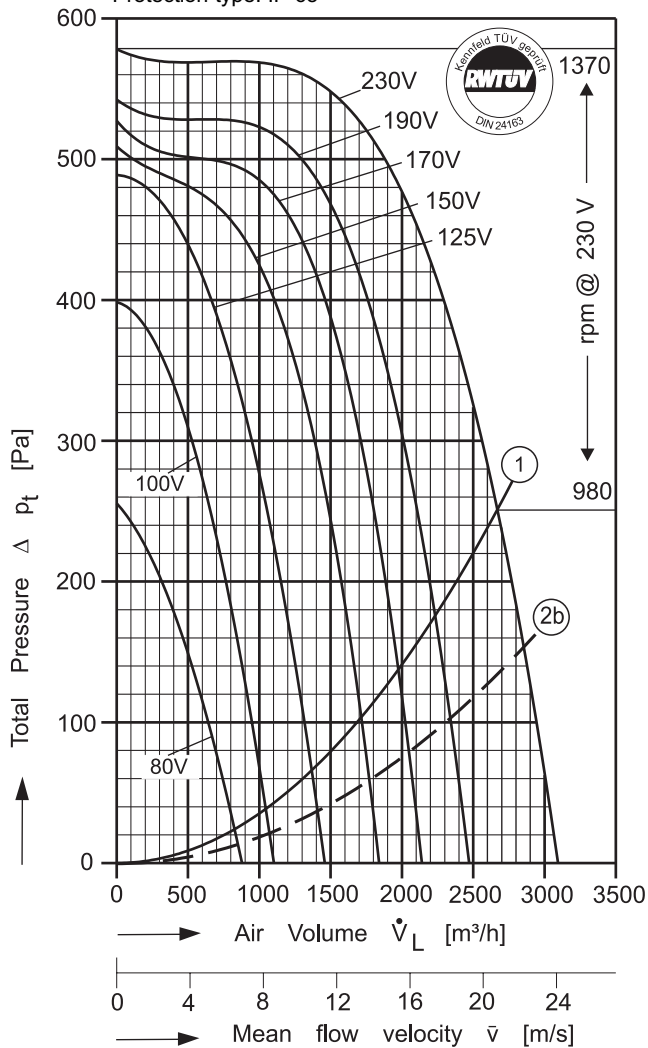

$P_{max} = 1,10 \text{ kW}$ $I_A / I_N = 1,7$ $I_{max} = 5,06 \text{ A}$

Voltage [V]	Air Volume \dot{V}_L [m³/h] at $\rho = 1,2 \text{ kg/m}^3$ and current [A] (bold figures, 2nd. line)							
	Free Air	Total Pressure Δp_t [Pa]						
		40	80	120	200	300	400	500
80	835 2,19	790 2,18	690 2,15	590 2,09	320 1,87			
100	1050 2,76		980 2,70	915 2,62	765 2,44	530 2,13		
125	1375 3,39		1345 3,34	1285 3,21	1150 3,05	950 2,72	665 2,27	
150	1705 3,87			1690 3,84	1580 3,67	1390 3,36	1110 2,89	
170	1965 4,59				1885 4,10	1710 3,79	1465 3,36	
190	2250 4,59				2190 4,49	2010 4,18	1760 3,75	1300 3,03
230	2690 5,06					2560 4,84	2290 4,42	1880 3,83

Save power and even more silent with FISCHBACH SPEED CONTROLLERS FISCHBACH AUTOMATIC CONTROLLERS

Voltage Control	Type*	Order-No.*
Stepless, 0 - 100% and 100% - 0	FDR 55	6163
Stepwise, 7 Steps	FDR 750	6202
FISCHBACH AUTOMATIC CONTROL **	FRA 55	6252

* For further details see resp. catalogue pages
** For details of sensors etc., on request

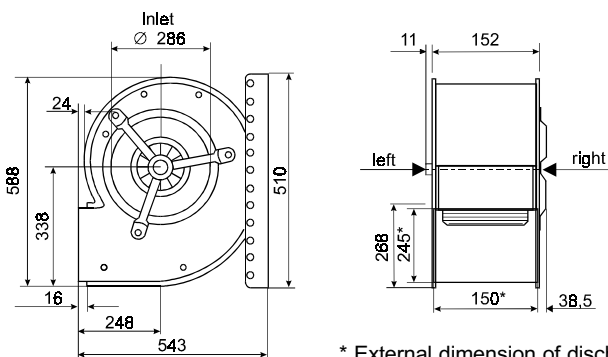

* External dimension of discharge

- ① System curve for dynamical pressure part related to fan discharge surface of $0,0357 \text{ m}^2$. Max. permissible air temperature: 60°C .
- ②b System curve incl. pressure regain by means of DIFFUSER ANGLE FRAME with connected duct. Duct length: 1,5 m



The Silent One

In the above diagram the **TOTAL** pressure (the sum of the dynamic and static pressures) is shown in relation to the air volume, dynamic pressure is shown below system line No.1. Static pressure is shown above that line.

To regain static pressure and reduce dynamic pressure connect a suitable transition piece on the fan outlet.