

Type: CFE = Single Inlet "Superflat" Performance / Dimensions

FISCHBACH
COMPACT
FAN

Type: CFE 930/D 1 [400V 3N~ 50 Hz]
Protection type: IP 65

Please state intake side !
For sound data please see extra pages.

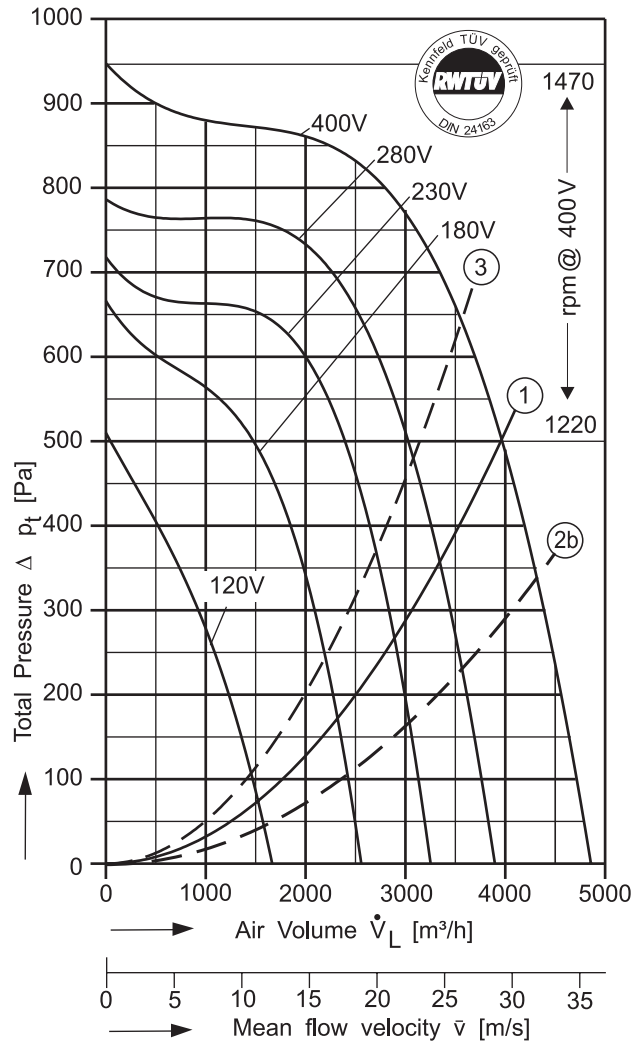

$P_{max} = 2,47 \text{ kW}$ $I_A / I_N = 2,0$ $I_{max} = 4,99 \text{ A}$

- ① System curve free air related to standard fan discharge surface of 0,0376 m². Max. permissible air temperature: 50° C
- ②b System curve incl. pressure regain by means of DIFFUSER ANGLE FRAME (FISCHBACH accessory) with connected duct. Duct length: 1,6 m.
- ③ For operating points above that curve a maximum air temperature of 60° C is allowed.

Voltage [V]	Air Volume \dot{V}_L [m ³ /h] at $\rho = 1,2 \text{ kg/m}^3$ and current [A] (bold figures, 2nd. line)						
	Free Air	Total Pressure Δp_t [Pa]					
		200	300	400	500	600	700
120	1530 3,08	1450 2,98	1040 2,48				
180	2320 3,98	2280 3,92	2090 3,62	1850 3,25	1480 2,72		
230	2900 4,38		2840 4,28	2640 3,96	2390 3,59	2000 3,06	
280	3360 4,56			3260 4,41	3030 4,08	2730 3,68	2270 3,14
400	3990 4,99				3970 4,97	3700 4,70	3350 4,39 2800 3,99

Save power and even more silent with FISCHBACH SPEED CONTROLLERS FISCHBACH AUTOMATIC CONTROLLERS		
Voltage Control	Type*	Order-No.*
Stepless, 0 - 100% and 100% - 0	FDR 55/3	6232
Stepwise, 5 Steps	FDR 5.5/3	6182
FISCHBACH AUTOMATIC CONTROL **	FRA 55/3	6282
Frequency Inverter FFU	on request	

* For further details see resp. catalogue pages
** For details of sensors etc., on request

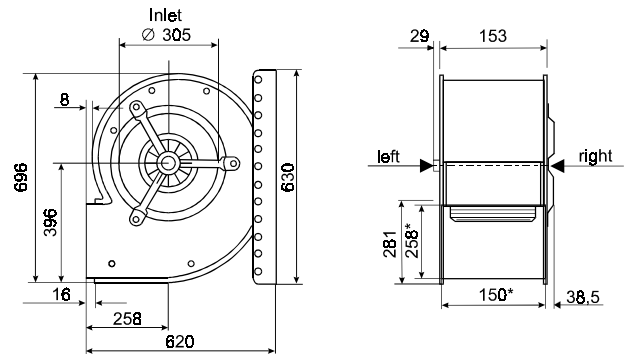

* External dimension of discharge

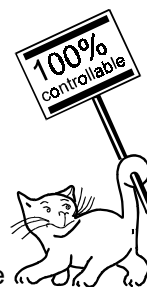

The Silent One

In the above diagram the **TOTAL** pressure (the sum of the dynamic and static pressures) is shown in relation to the air volume, dynamic pressure is shown below system line No.1. Static pressure is shown above that line.

To regain static pressure and reduce dynamic pressure connect a suitable transition piece on the fan outlet.

We do not guarantee for fans not being operated in consideration of those restrictions.