

Type: D = Double Inlet

Performance / Dimensions

**FISCHBACH
COMPACT
FAN**

Type: D 730/E 35 [230V 1N~ 50 Hz]

MP Capacitor 25 μ F - 400 VDB
Protection type: IP 65

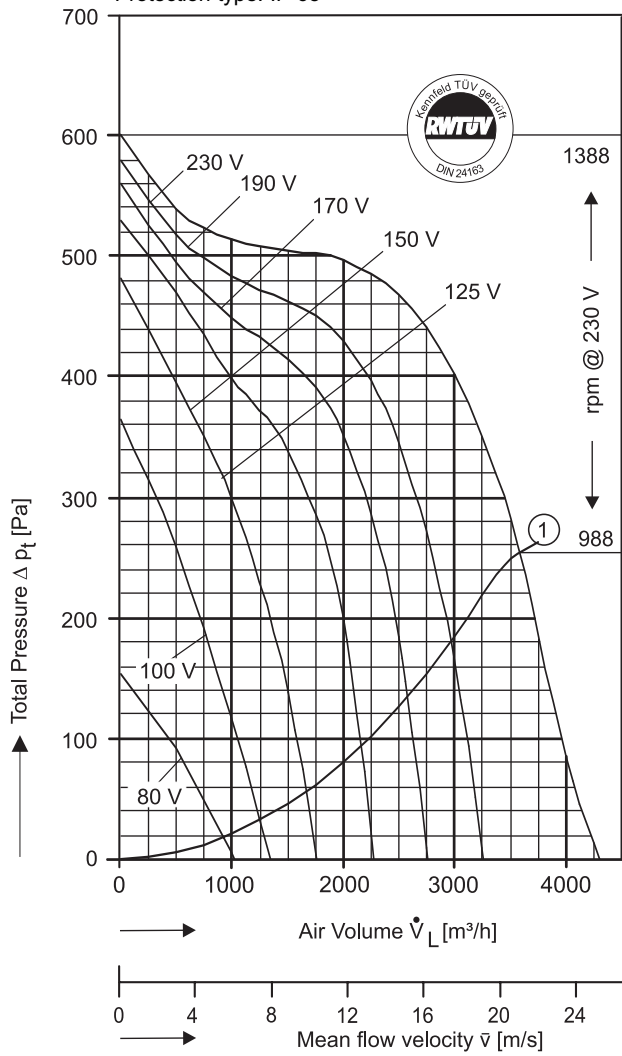

$P_{max} = 1,117 \text{ kW}$ $I_A / I_N = 1,7$ $I_{max} = 5,29 \text{ A}$

① System curve for dynamical pressure part related to fan discharge surface of 0,0469 m². For operating points above that curve a max. air temperature of 70° C is allowed (Curve for free blowing fan).

For sound data please see extra pages.

Voltage [V]	Air Volume \dot{V}_L [m ³ /h] @ $\rho = 1,2 \text{ kg/m}^3$ and Current [A] (bold figures, 2nd. line)							
	Free Air	Total Pressure Δp_t [Pa]						
		150	200	250	300	350	400	450
80	950 2,35	230 2,11						
100	1215 2,94	1020 2,76	710 2,50	520 2,40	310 2,25			
125	1683 3,64	1487 3,39	1330 3,18	1190 3,03	980 2,70	770 2,50	420 2,32	
150	2175 4,17	2118 4,05	1975 3,80	1850 3,66	1682 3,44	1408 3,09	920 2,62	680 2,30
170	2598 4,58		2450 4,28	2350 4,15	2184 3,91	2024 3,69	1672 3,25	1024 2,44
190	2983 4,98		2900 4,80	2790 4,62	2643 4,35	2575 4,15	2250 3,85	1690 3,15
230	3594 5,29				3422 5,06	3210 4,78	3005 4,53	2710 4,18

Save power and even more silent with FISCHBACH SPEED CONTROLLERS FISCHBACH AUTOMATIC CONTROLLERS

Voltage Control	Type*	Order-No.*
Stepless, 0 - 100% and 100% - 0	FDR 55	6163
Stepwise, 7 Steps	FDR 750	6202
FISCHBACH AUTOMATIC CONTROL**	FRA 55	6252

* For further details see resp. catalogue pages
** For details of sensors etc., on request

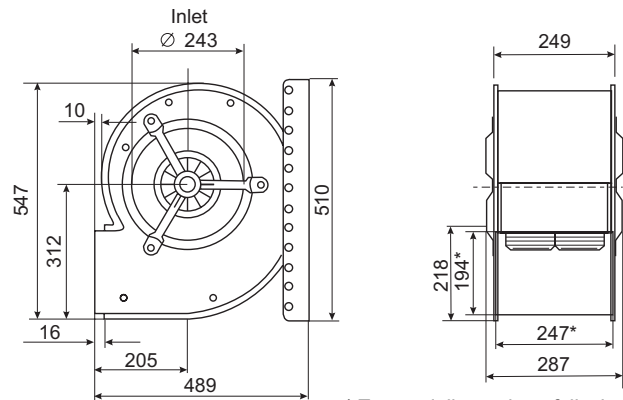

* External dimension of discharge

**100%
controllable**

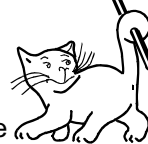

The Silent One

In the above diagram the **TOTAL** pressure (the sum of the dynamic and static pressures) is shown in relation to the air volume, dynamic pressure is shown below system line No.1. Static pressure is shown above that line.