

Type: D = Double Inlet

Performance / Dimensions



Type: D 770/D 1 [380V 3N~ 60 Hz]
Protection type: IP 65

For sound data please see extra pages.

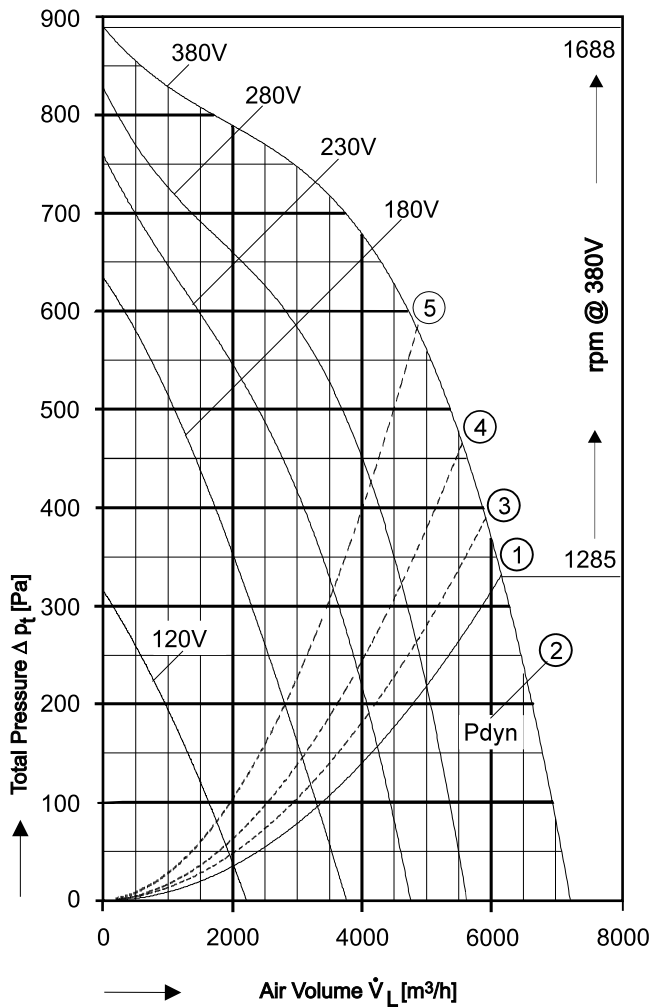

Voltage [V]	Air Volume \dot{V}_L [m³/h] at $\rho = 1,2 \text{ kg/m}^3$ and current [A] (bold figures)							
	Free Air	Total Pressure Δp_t [Pa]						
		200	300	400	500	600	700	750
120	2010 3,12	785 2,66						
180	3305 4,31	2290 3,53	1730 3,16	1100 2,81				
230	4228 4,93	4075 4,78	3640 4,30	3100 3,93	2395 3,42	1475 2,87		
280			4705 5,03	4270 4,63	3695 4,15	2820 3,52	1365 2,74	
380				5870 5,60	5370 5,19	4725 4,72	3745 4,11	2940 3,70

Save power and even more silent FISCHBACH SPEED CONTROLLERS Manual and Automatic		
Voltage Control	Type*	Order-No.*
Stepless 0 - 100% and 100% - 0	FDR 80/3	6232
Stepwise 5 Steps	FDR 7.8/3	6173
FISCHBACH AUTOMATIC CONTROL **	FRA 80/3	6282

* For further details see resp. catalogue pages
** For details of sensors etc., on request

- ① Free air relating to fan discharge area 0,072 m².
- ② Velocity (dynamic) pressure
For Static Pressure Regain see example
- ③ Max. permissible ambient temperature 30°C above this curve. Do not operate fan below this curve.
- ④ Max. permissible ambient temperature 45°C.
- ⑤ Max. permissible ambient temperature 60°C.

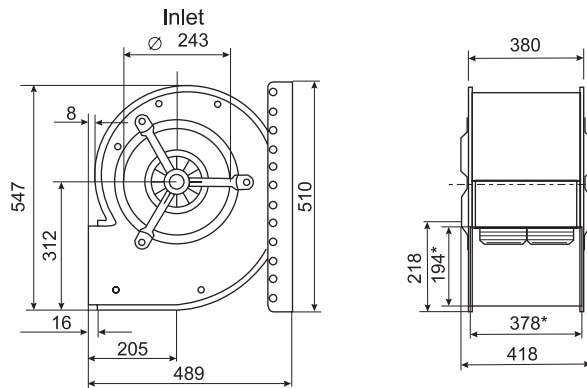

* External dimension of discharge



The Silent One