

Type: DS = Double Inlet

Performance / Dimensions



Type: DS 6-770/E 65 [220V 1N~ 60 Hz]

MP Capacitor 30 μ F - 400 VDB
Protection type: IP 65

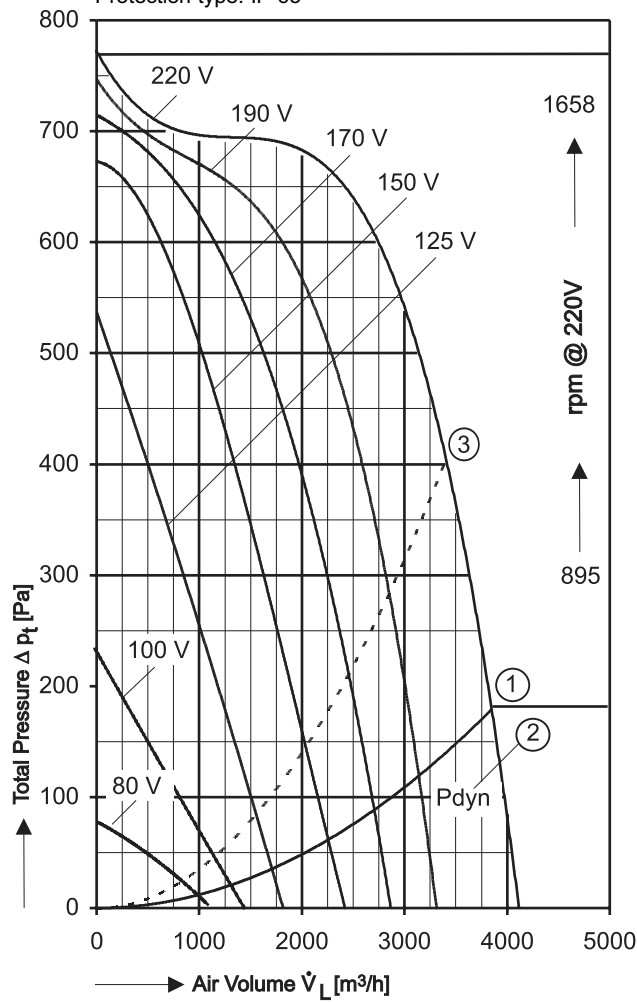

- ① Free air relating to fan discharge area 0,072 m². Max. permissible ambient temperature 45°C.
- ② Velocity (dynamic) pressure
For Static Pressure Regain see example
- ③ Max. permissible ambient temperature 60°C.

For sound data please see extra pages.

Voltage [V]	Air Volume \dot{V}_L [m ³ /h] at $\rho = 1,2 \text{ kg/m}^3$ and current [A] (bold figures)							
	Free Air	Total Pressure Δp_t [Pa]						
		100	200	300	400	500	600	700
80	1000 2,10							
100	1310 2,69	805 2,70						
125	1720 2,67	1505 2,68	1180 2,69	850 2,70				
150	2255 4,21	2155 4,20	1895 4,19	1630 4,19	1345 4,18			
170	2700 4,84	2680 4,84	2475 4,81	2245 4,78	1965 4,76	1620 4,73		
190	3135 5,43		3010 5,41	2820 5,38	2585 5,35	2290 5,31	1810 5,25	
220	3850 6,31		3815 6,30	3630 6,26	3410 6,20	3135 6,13	2730 6,03	2385 5,96

Save power and even more silent FISCHBACH SPEED CONTROLLERS Manual and Automatic		
Voltage Control	Type*	Order-No.*
Stepless 0 - 100% and 100% - 0	FDR 80	6164
Stepwise 7 Steps	FDR 750	6202
FISCHBACH AUTOMATIC CONTROL **	FRA 80	6253

* For further details see resp. catalogue pages
** For details of sensors etc., on request

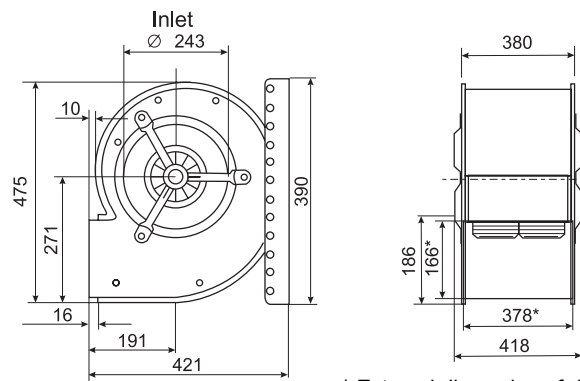

* External dimension of discharge



The Silent One