

Type: HE = single inlet

Performance / Dimensions



Type: HE 630/D 5 [400V 3 N~ 50 Hz]  
Protection type: IP 65

For sound data please see extra pages.

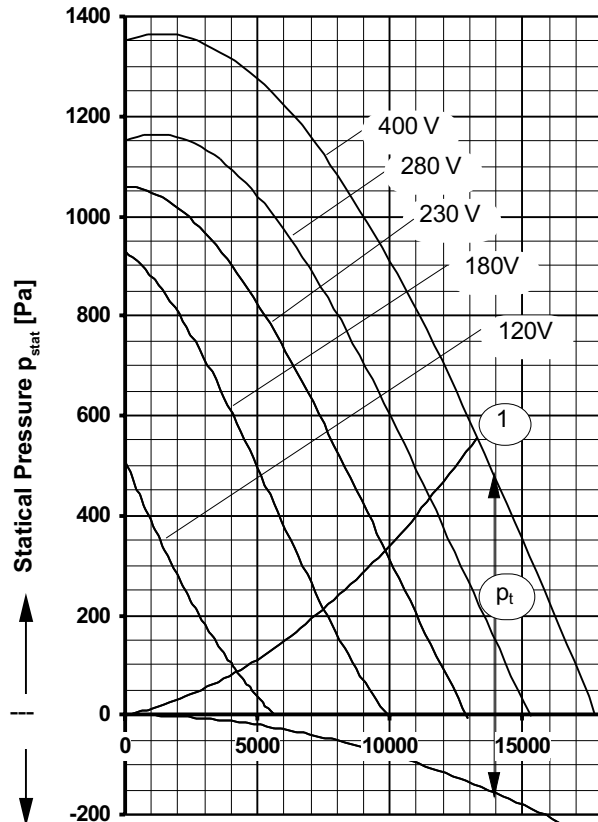

$\rightarrow$  Air Volume [m<sup>3</sup>/h]  
 $\rightarrow$  Mean flow velocity  $\bar{v}$  [m/s]  
 $p_t$  : Total Pressure =  $p_{dyn} + p_{stat}$

$P_{max} = 7,30 \text{ kW}$      $rpm_{max} = 1415 \text{ min}^{-1}$   
 $I_{max} = 16,10 \text{ A}$      $I_A/I_N = 3,1$

**Max. permissible Air Inlet Temperature:**  
 Below system curve (1): 55°C  
 Above system curve (1): 60°C

Voltage [V]	Air Volume $\dot{V}_L$ [m <sup>3</sup> /h] at $\rho = 1,2 \text{ kg/m}^3$ and current [A] (bold figures, 2nd. line)							
	Free air	Statical Pressure [Pa]						
		200	400	600	800	900	1100	1200
120	5600 <b>10,95</b>	2800 <b>10,42</b>						
180	9950 <b>15,04</b>	7600 <b>14,28</b>	5800 <b>13,28</b>	4100 <b>11,99</b>	2100 <b>10,05</b>			
230	12900 <b>16,07</b>	10950 <b>15,48</b>	9200 <b>14,69</b>	7300 <b>13,54</b>	5250 <b>11,97</b>	2450 <b>9,27</b>		
280	15250 <b>15,93</b>	13550 <b>15,43</b>	11850 <b>14,79</b>	10100 <b>14,00</b>	8100 <b>12,92</b>	6800 <b>12,12</b>	5700 <b>11,38</b>	
400	17700 <b>15,38</b>	16200 <b>15,10</b>	14600 <b>14,75</b>	12900 <b>14,33</b>	11100 <b>13,81</b>	10100 <b>13,50</b>	7800 <b>12,71</b>	6300 <b>12,14</b>

Save power and even more silent FISCHBACH SPEED CONTROLLERS FISCHBACH AUTOMATIC CONTROLLERS		
Voltage Control	Type	Order No.
Stepless, 0 - 100% and 100% - 0	FDR 200/3	<b>6235</b>
Stepwise, 5 steps	FDR 20/3	<b>6177</b>
FISCHBACH AUTOMATIC CONTROL	FRA 200/3	<b>6285</b>
Frequency Inverter	on request	
Controller FDR and FRA with casing is standard with integrated motor protection and outlet fuses		

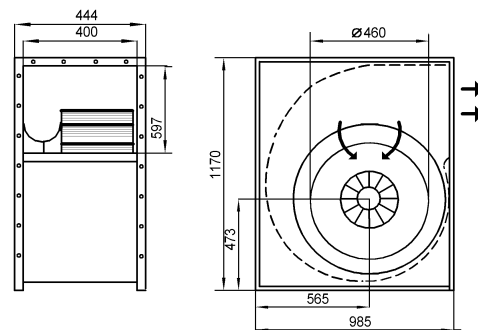

The Silent One